

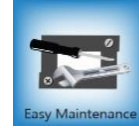

<b>Code:</b>	<b>COLD UNITS</b>	<b>Model:</b>
133701010	<b>ADVANCE F 70-4 FREEZER CABINET</b>	ADVANCE F 70-4



**MAIN FEATURES**

- \* GN 2/1 size freezer with single door
- \* 430 quality stainless steel
- \* Operating temperature -25 / -12 °C
- \* Clean free condenser
- \* Maximum internal capacity minimal temperature increase during defrost.
- \* Most efficient air distribution inside with a specially designed air channel.
- \* The inner liners and inner lower base which are moulded comply with the highest hygiene standards with rounded corners and are made of stainless steel.
- \* Monoblock design
- \* Automatic fan cutout switch and internal led light
- \* Wide magnetic removable gasket with triple indulation area provides an effective seal which reduces heat lost.
- \* 40-42 kg/m3 density environment friendly HFC-Free Polyurethane insulation for low energy consumption (60 mm)
- \* Protecting Class (IP2X)
- \* Ventilated cooling design
- \* Reversible door allows the appliances to be adapted to any individual installation site.

**OPTIONS**

- \* **Leg Option:** Leg/Castor
- \* **Shelf Option:** Nylon/Stainless
- \* **Plug Option:** UK/EU
- \* **Door Option:** Left Hinged / Right Hinged

**ACCESSORIES**

- \* Plastic coated shelf 4 Pcs.

**STANDARDS**

- \* EN 60335-1 European Standard relating to safety of household and similar electrical appliances
- \* EN 60335-2-89 European Standard relating to particular requirements for commercial refrigerating appliances with an incorporated or remote refrigerant unit or compressor
- \* ISO 22041 Refrigerated storage cabinets and counters for professional use Performance and energy consumption





<b>Code:</b>	<b>COLD UNITS</b>	<b>Model:</b>
133701010	ADVANCE F 70-4 FREEZER CABINET	ADVANCE F 70-4

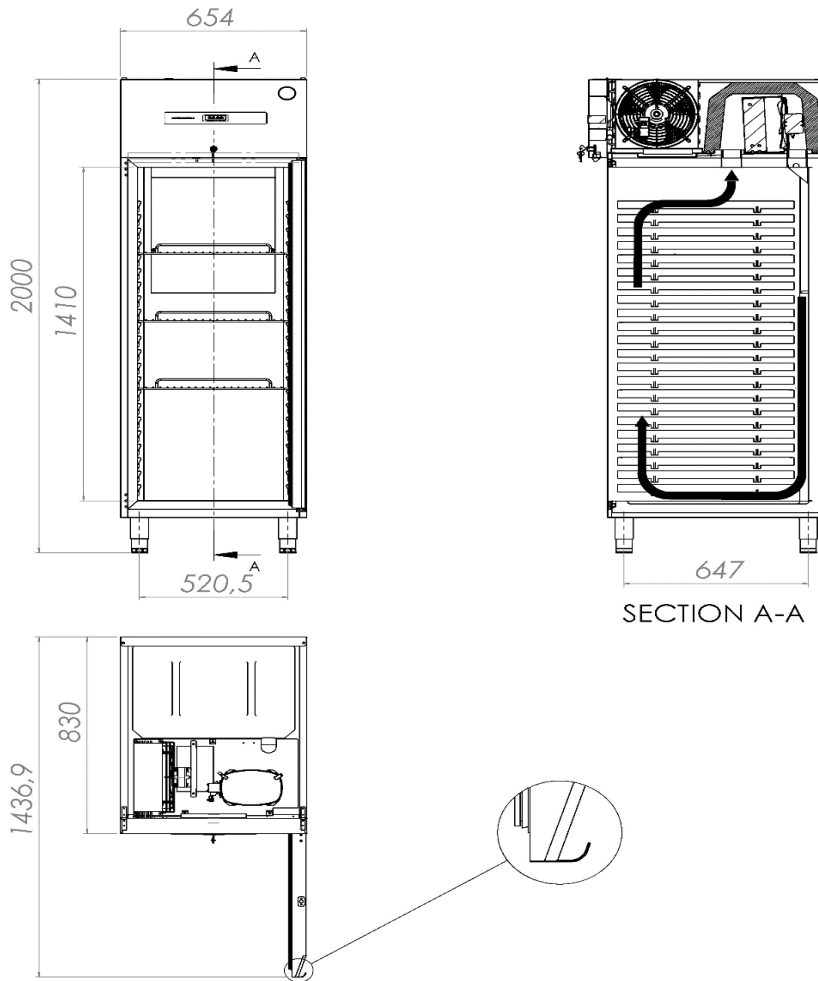

DIMENSIONS (Net)		DIMENSIONS (Shipping)	
* Width (mm) :	654	* Width (mm):	704
* Depth (mm) :	830	* Depth (mm):	880
* Height (mm) :	2000	* Height (mm):	2150
* Weight (kg) :	123	* Weight (kg):	133
		* Volume (m³):	1,33

TECHNICAL SPECIFICATIONS			
* Gross Volume:	600 L	* Cooling Temperature:	-25/-12 °C
* Net Volume:	420 L	* Cooling Gas Type:	R290
* Climate Class:	CC5 (+40 °C - %40 Rh)	* Cooling Capacity:	606 W (-30° / +45°)
* Energy Efficiency Class:	D	* Supply Voltage:	230V / NPE 50 Hz
* Energy Efficiency Index:	61,31	* Protection Class:	IP 2X
* Energy Consumption:	5,949 kW/24h	* Cooling System Design:	Ventilated

